

Cojinete fijo con pasador en inox.
 Davier fixe avec barette en inox.
 Bow roller with safety pin in stainless steel.

REF.	☐ Tot	Base ☐	⏏	A	Mod
40250637	231	174	51	56	Inox/SS.

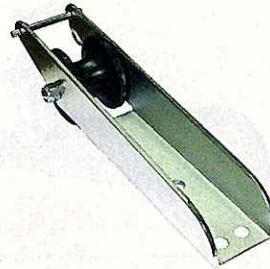
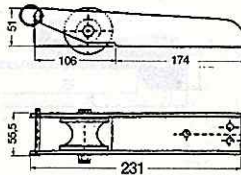

Cojinete fijo con pasador en inox.
 Davier fixe avec barette en inox.
 Bow roller with safety pin in stainless steel.

REF.	☐ Tot	Base ☐	⏏	A	Mod
40250640	231,5	138,5	83	51	Inox/SS.

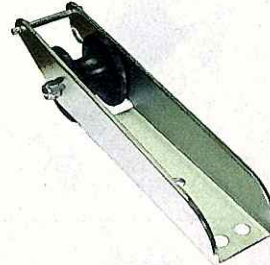
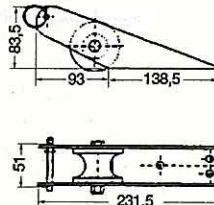

NEW

Cojinete de ancla fijo.
 Davier fixe. / Bow roller. Inox / S.S.

REF.	Mod	☐ ⏏	Roller
40251432	A	222x66,7mm.	50,8mm.
40251433	B	387,4x52,4mm.	63,5mm.

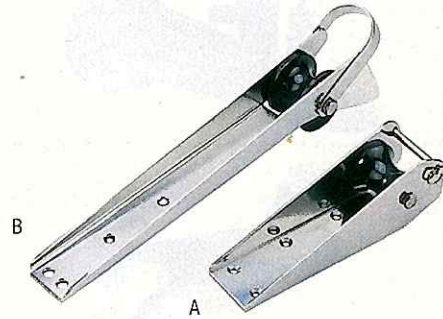

Cojinete ancla en inox de 4 mm. de espesor.
 Davier en inox de 4 mm. d'épaisseur.
 Stainless steel bow roller, 4mm. thick plate.

REF.	☐ Tot	Base ☐	⏏	A	Mod	☑ ☑
00111102	240	140	75	60	Inox/SS.	10-12
00111103	330	225	80	60	Inox/SS.	10-12

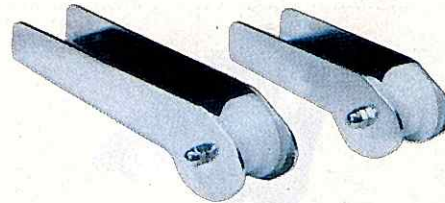

Cojinete ancla. Inox con bloqueo.
 Davier en inox. Avec bloqueur.
 Bow roller. In stainless steel with lock.

REF.	☐ Tot	Base ☐	⏏	A	Mod	☑ ☑
00111132	275	155	115	50	Inox/SS.	6-12

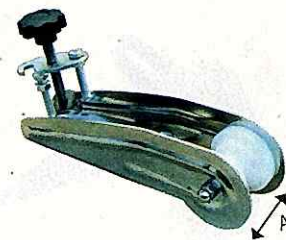

NEW

Cojinete de ancla.
 Davier. / Bow roller.
 Inox / S.S.

REF.	☐ ⏏
41250663	325x50mm.

